

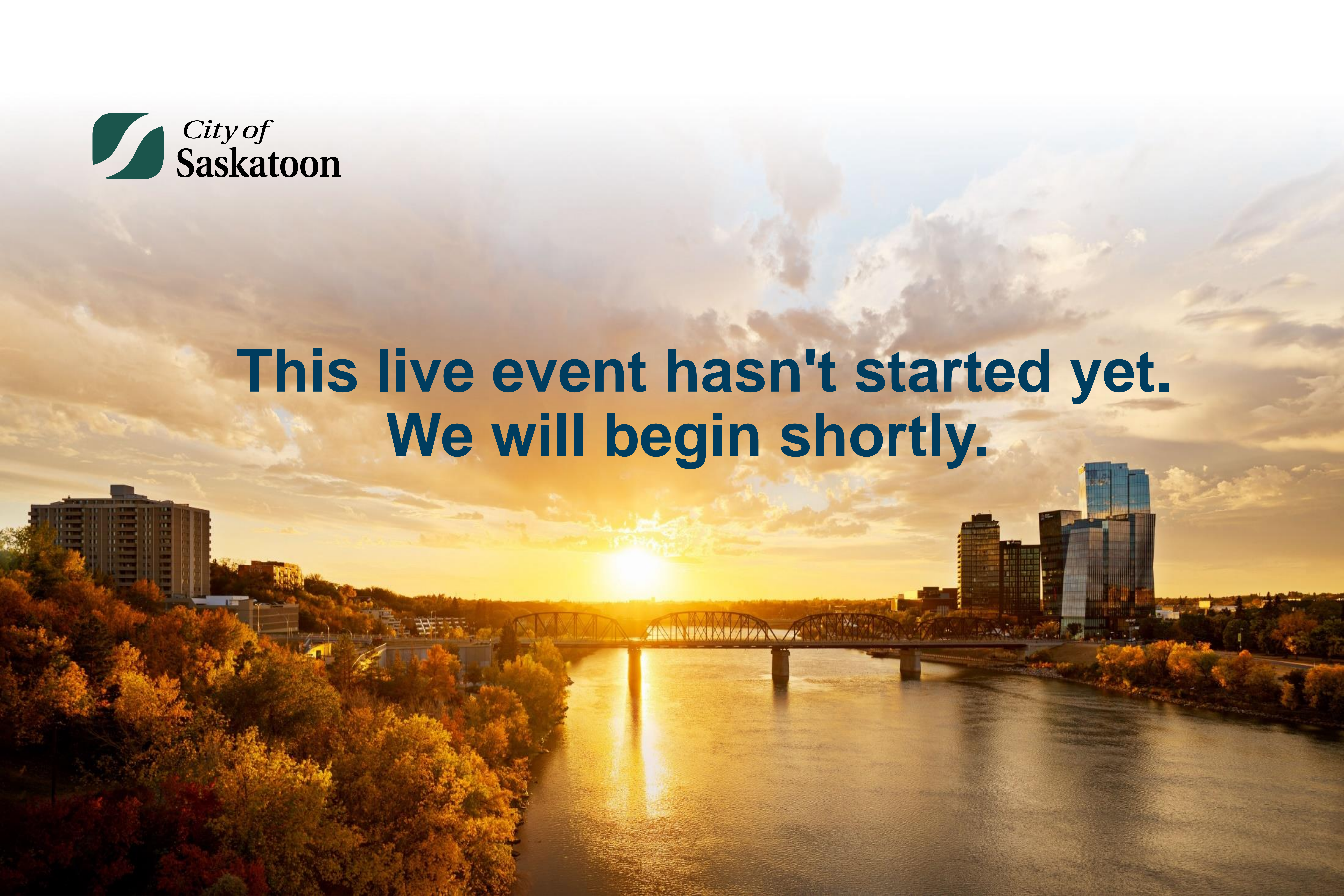

**This live event hasn't started yet.
We will begin shortly.**





2nd Avenue North Parking and Public Realm Project

**Virtual Information Session
June 2024**



Land Acknowledgement

Welcome



Agenda:

- Session Process and Microsoft Teams Overview
- Existing Conditions
- Options Considered
- Questions and Answers
- Wrap up

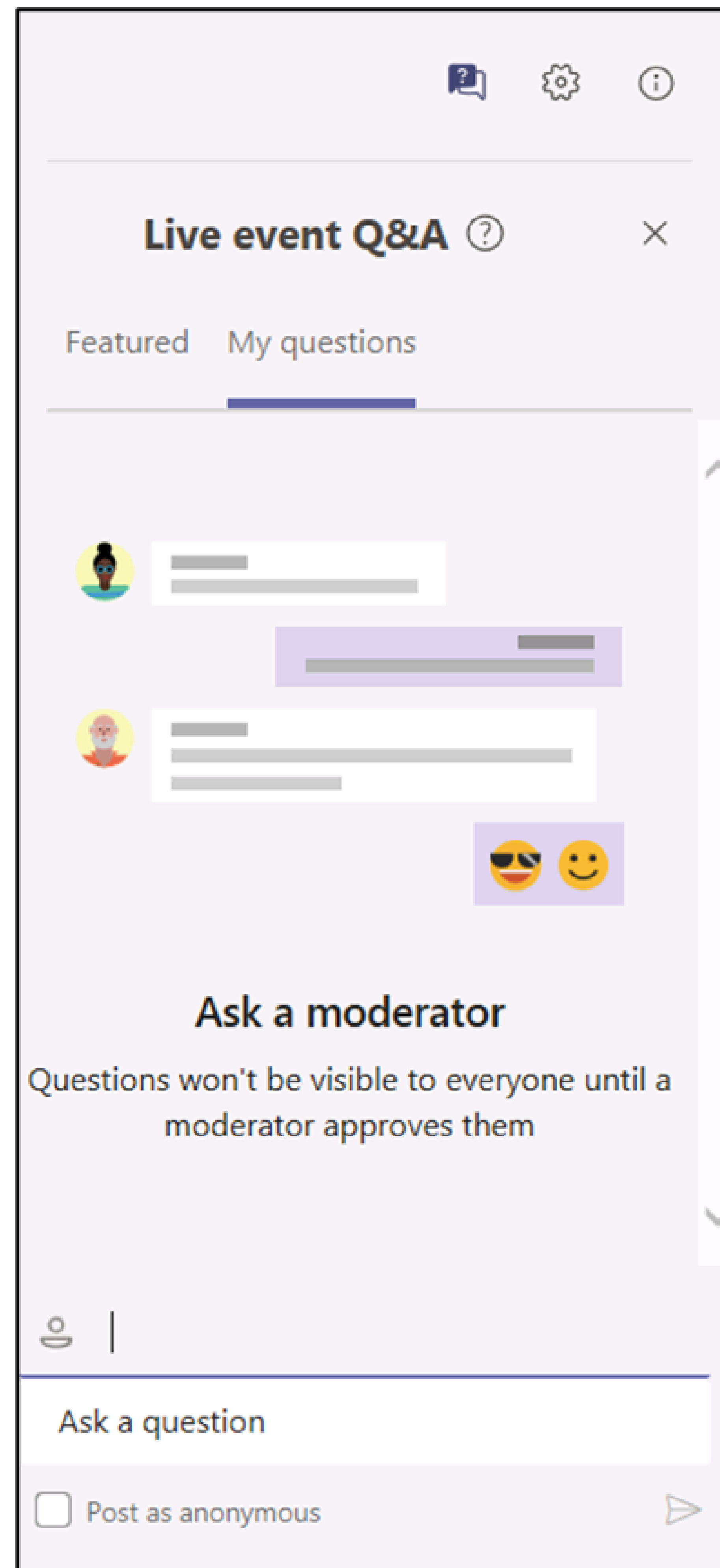
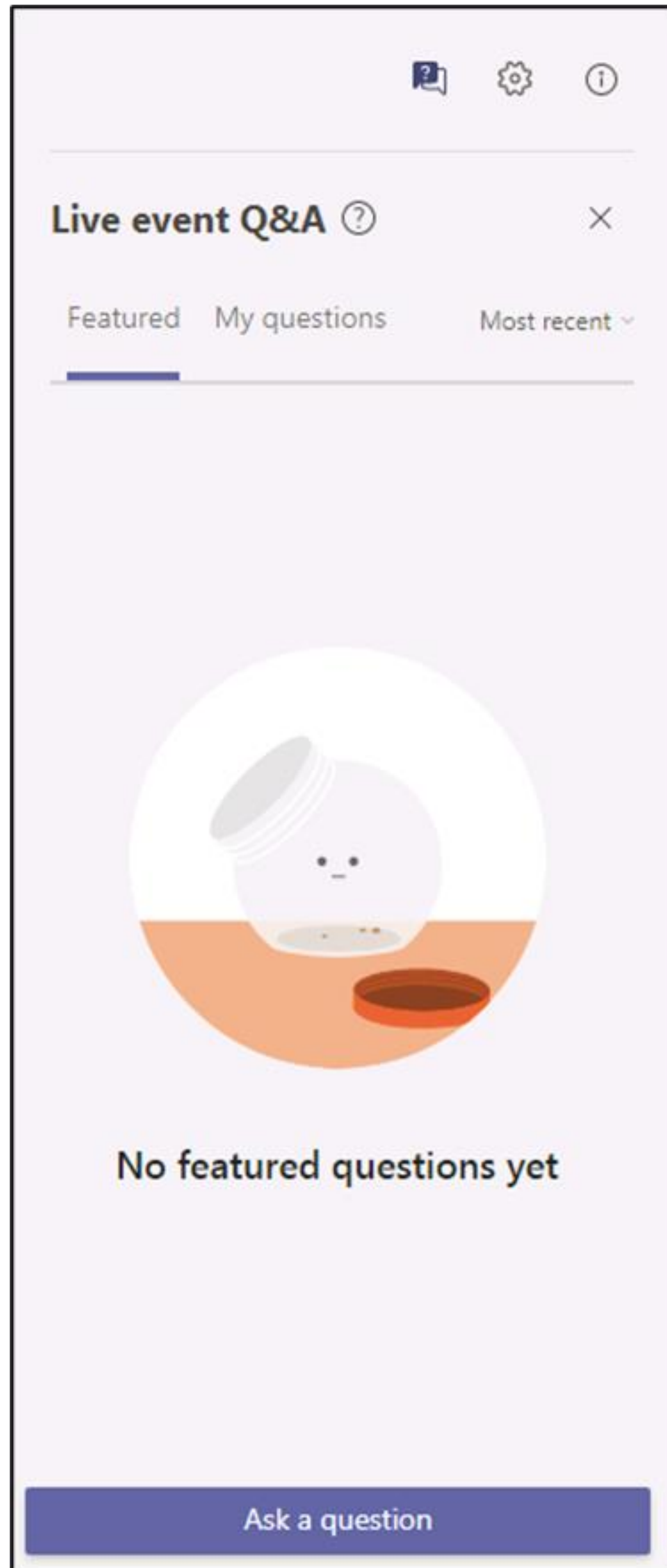

Microsoft Teams

Additional Help?

Message Sarah in the chat or email sbeer@islengineering.com

Additional information is available at the [Microsoft Support website](#).

Project Overview



Why Are We Doing This?

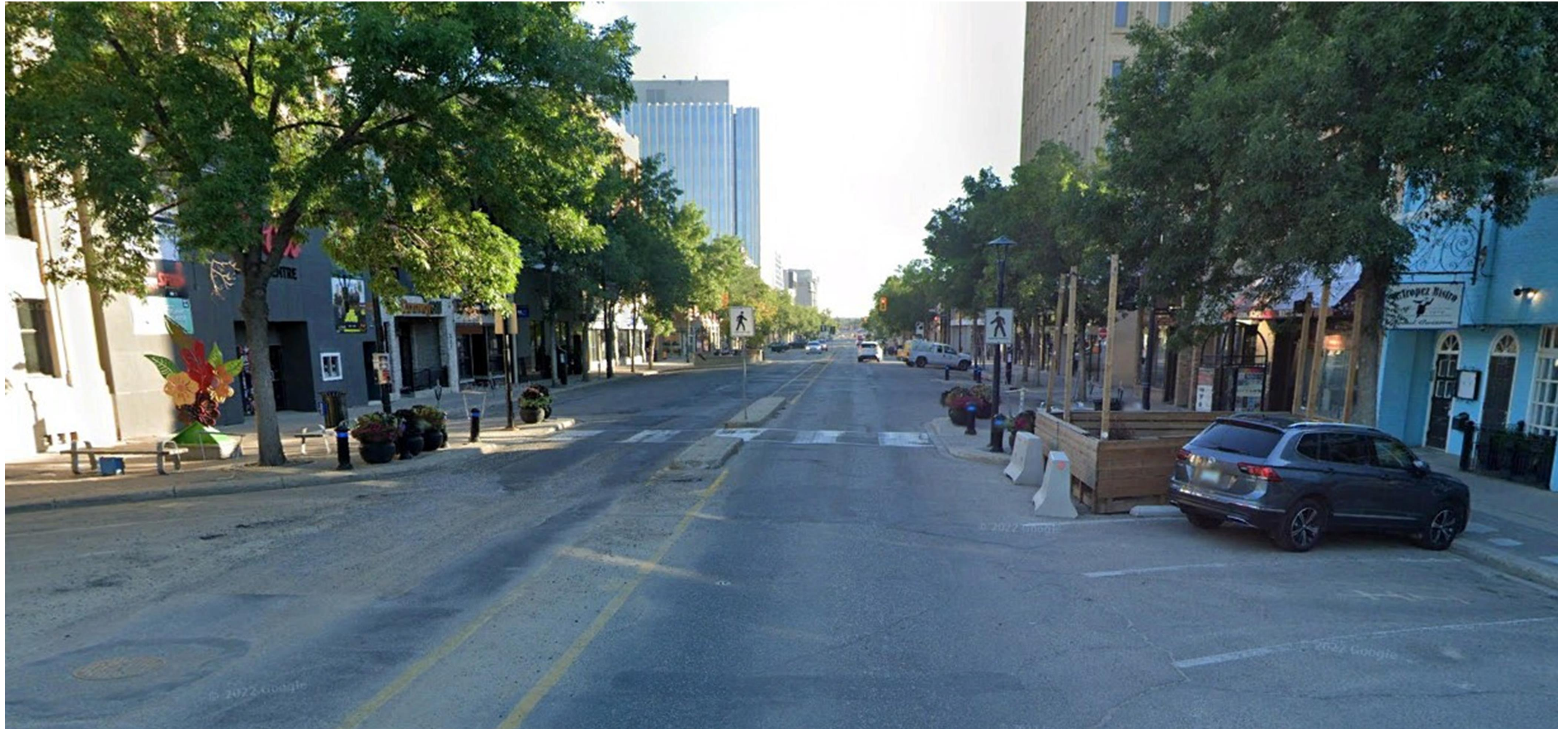

Project Overview

Phase 1 Existing Conditions

- Interested party engagement
- Background and existing conditions review

Phase 2 Concept Development

- Evaluate options
- Public and interested party engagement

We Are Here

Phase 3 Functional Plan

- Draft plan
- Functional design

Existing Conditions - 25th Street



- 2nd Avenue @ 25th Street looking South
- Future library parcel fenced off on right side of photo
- Four through traffic lanes (two each way), plus left turn lanes and parallel parking lanes (7 lanes total)
- 1.8m sidewalk, vertical curb
- Limited space for plantings

Existing Conditions – 25th Street



- 2nd Avenue @ 25th Street looking north
- Future library parcel on left side of photo
- Four through traffic lanes (two each way), plus left turn lane and parallel parking lanes (7 lanes total)
- 1.8m sidewalk, vertical curb
- Limited space for plantings

Existing Conditions - 24th Street



- 2nd Avenue @ 24th Street looking north
- Future library fenced off on left side of photo
- Four through traffic lanes (two each way), plus left turn lanes and parallel parking lanes (7 lanes total)
- Concrete median, vertical curbs

Existing Conditions - 23rd Street



- 2nd Avenue @ 23rd Street looking south
- Switches from two through lanes with angle parking to four through lanes with parallel parking
- Concrete median, vertical curbs
- Curb extensions present

What We Learned



- Accessible Parking and Street Access
- Pedestrian Safety and Sustainable Infrastructure
- Traffic and Public Transit Management
- Community Amenities and Urban Design

Option Evaluation

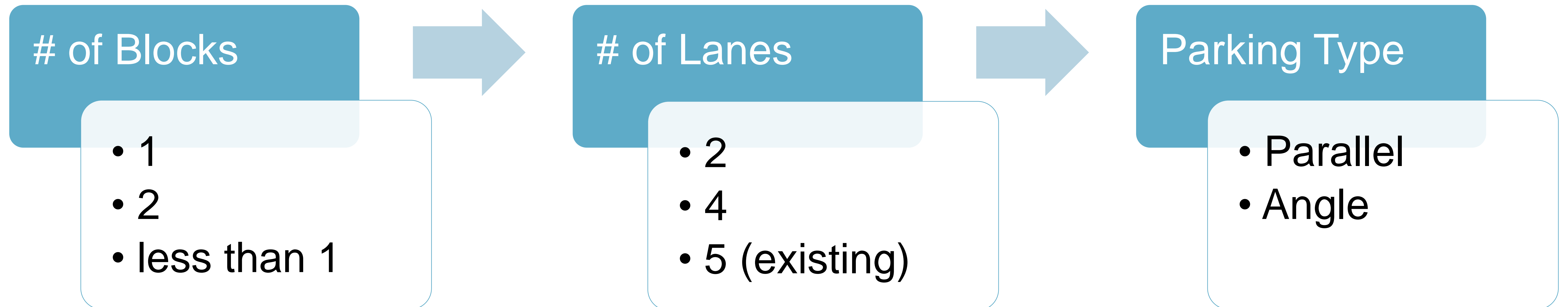

Option Evaluation

Option 1
No Changes

Do Nothing

Option 2
Both Blocks

2 Lanes
Angle

2 Lanes
Parallel

4 Lanes
Parallel

Option 3
North Block

2 Lanes
Angle

2 Lanes
Parallel

4 Lanes
Parallel

Option 4
Minor Changes

Accessible
Parking
Spaces

Evaluation Criteria

- Improved Public Gathering Spaces and Community Features
- Aligns with City Centre Plan and DEED objectives
- Accessibility
- Impacts to Parking
- Landscaping Opportunity
- Impact on Traffic Safety
- Impact on Traffic Operations
- Impact on Utilities
- Construction Costs

Option 1



- Do Nothing
- No Cost
- No Benefits
- Does not meet Library's need for accessible parking

Option 2A – Angle Parking – South Block

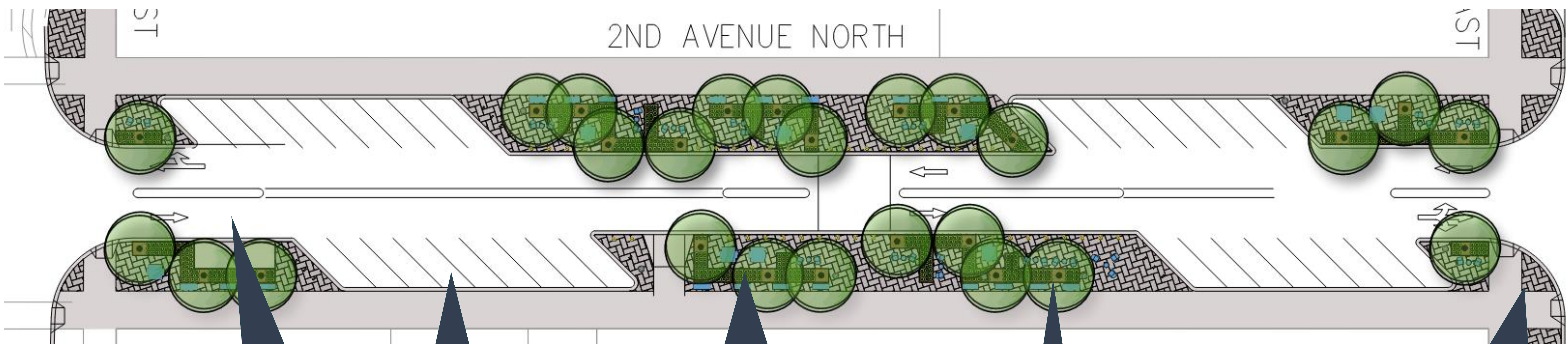

2 driving lanes

Angle Parking

Large Seating Areas

Trees

Curb Extensions

Estimated cost: \$6.0 million (\$3.0 million per block)

Option 2A – Angle Parking – North Block



2 driving lanes

Angle Parking

Large Seating Areas

Trees

Curb Extensions

Estimated cost: \$6.0 million (\$3.0 million per block)

Option 2A – Angle Parking

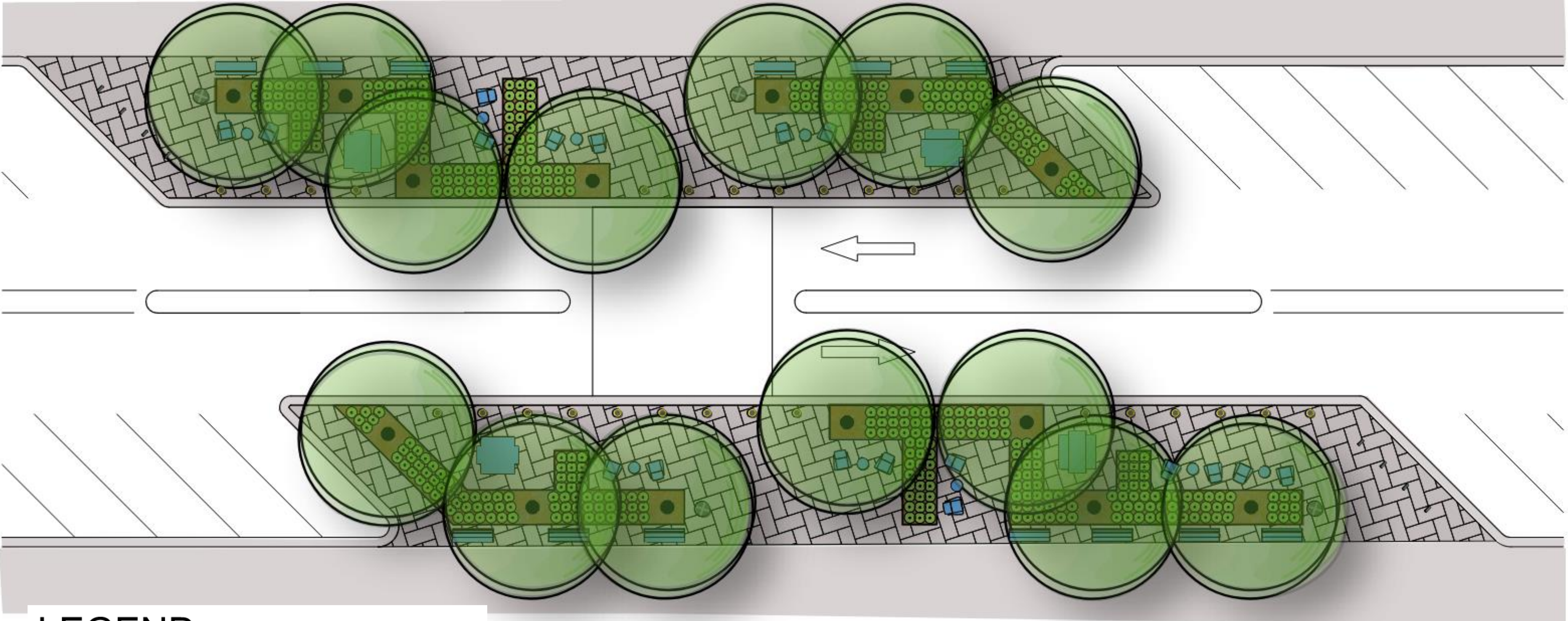

LEGEND

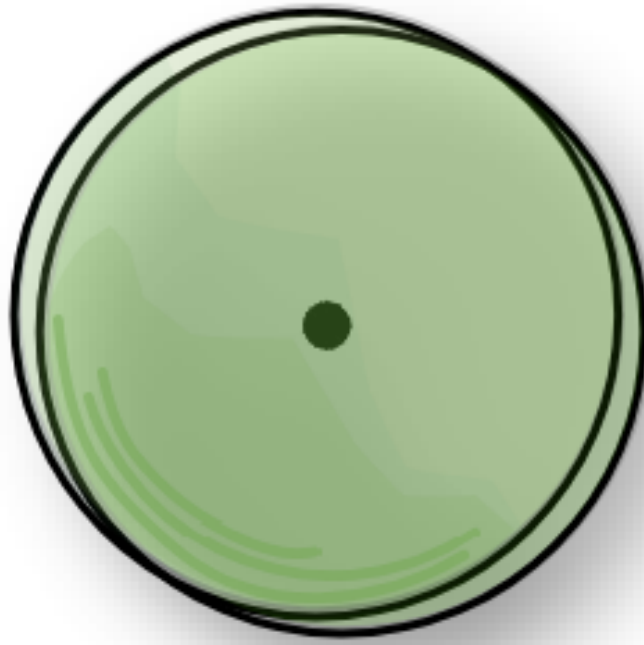

BOULEVARD TREE



GRASSES



PICNIC TABLE



TRASH RECEPTACLE



BIKE RACK



BENCH



MOVEABLE FURNITURE

Option 3B – Parallel Parking



4 driving lanes

Parallel Parking

Limited Seating Areas

Trees

Curb Extensions

Estimated cost: \$2.6 million

Option 3B – Parallel Parking

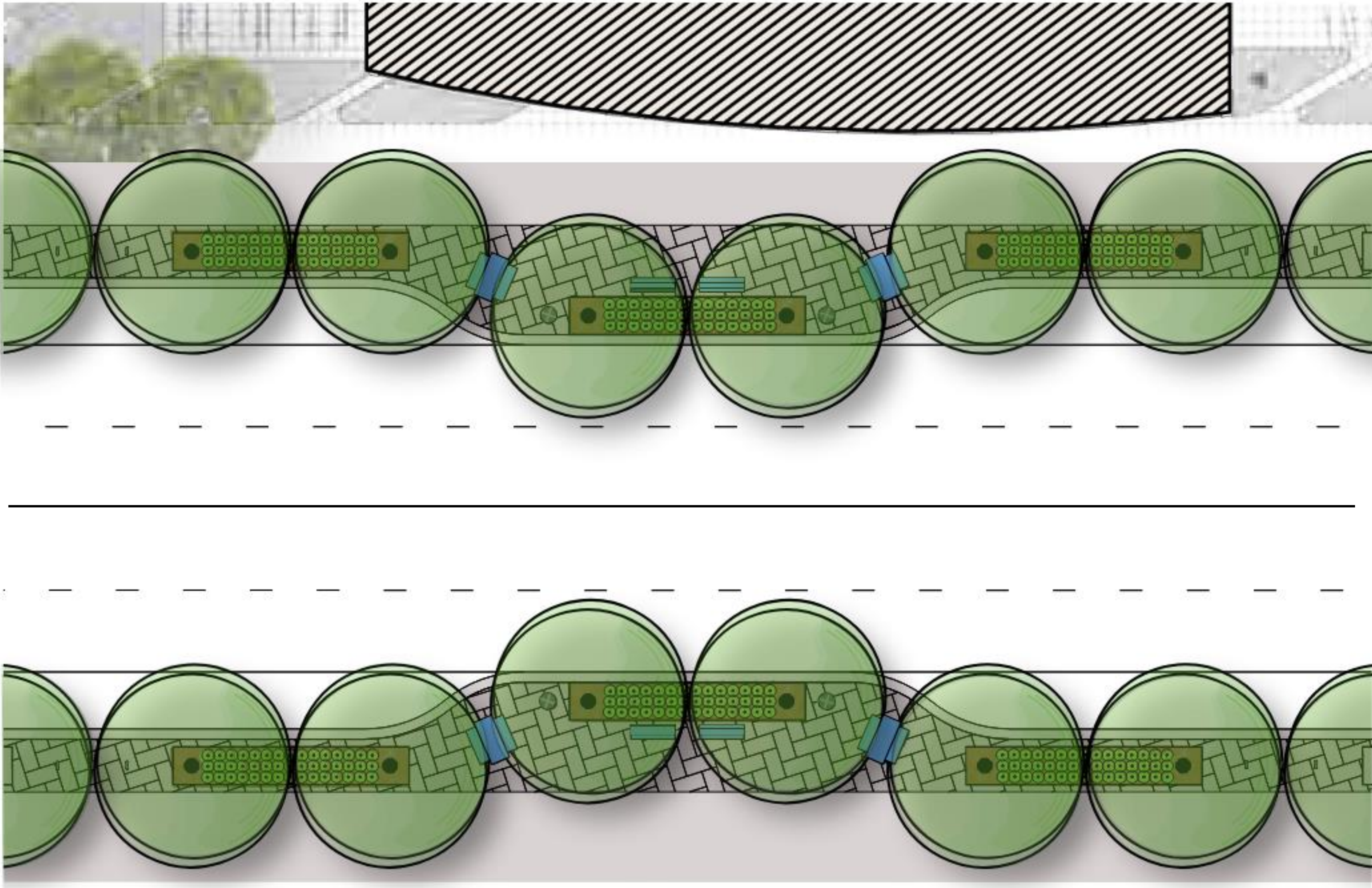

LEGEND

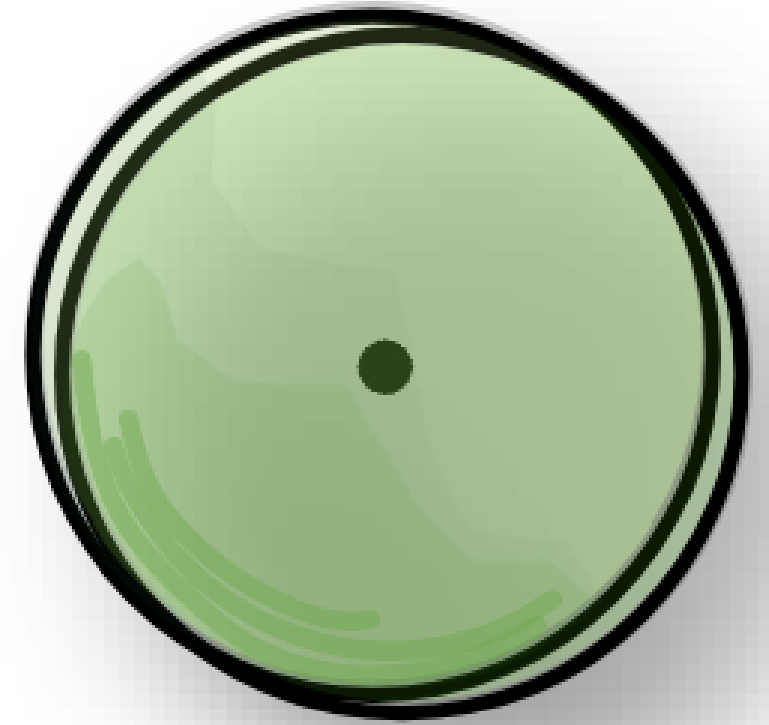

BOULEVARD TREE



GRASSES

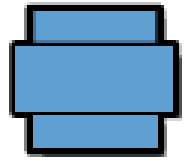

PICNIC TABLE



TRASH RECEPTACLE



BIKE RACK



BENCH

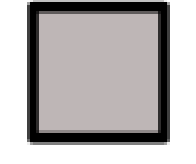

TREE GRATE

Option 4 – Accessible Parking



Curb Extension

Accessible Parking Spaces

Estimated Cost: \$300,000

Option 4 – Accessible Parking



LEGEND

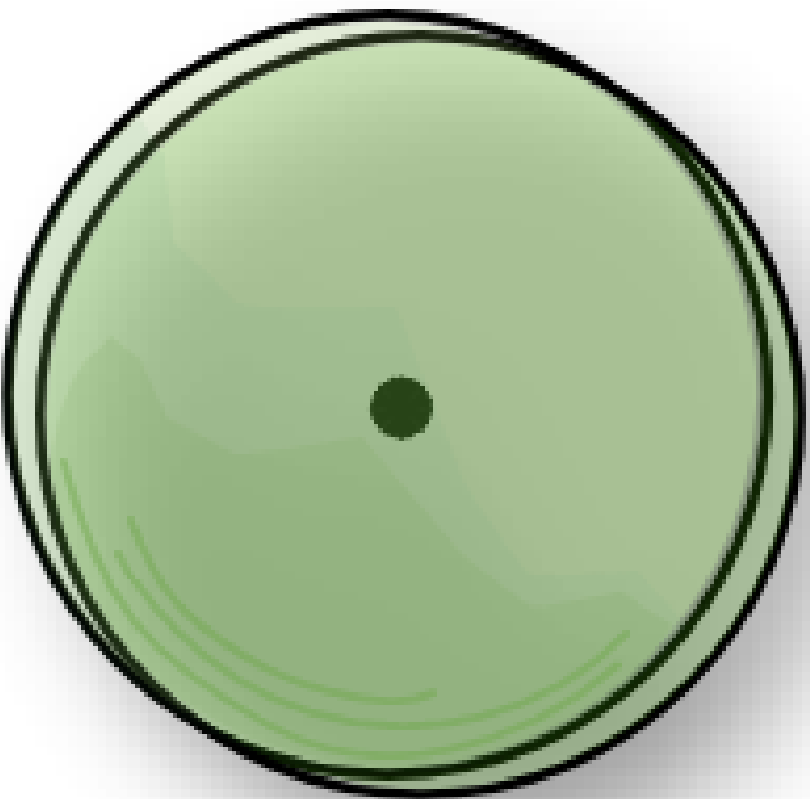

PROPOSED TREE

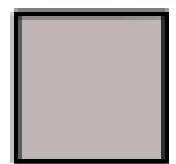

TREE GRATE



TRASH RECEPTACLE



BIKE RACK



BENCH

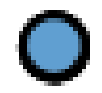

PLANTER POT



BOLLARD

Option 2A: Preferred Long-Term Plan



Estimated cost: \$6.0 million (\$3.0 million per block)

Option 4: Preferred Short-Term Plan

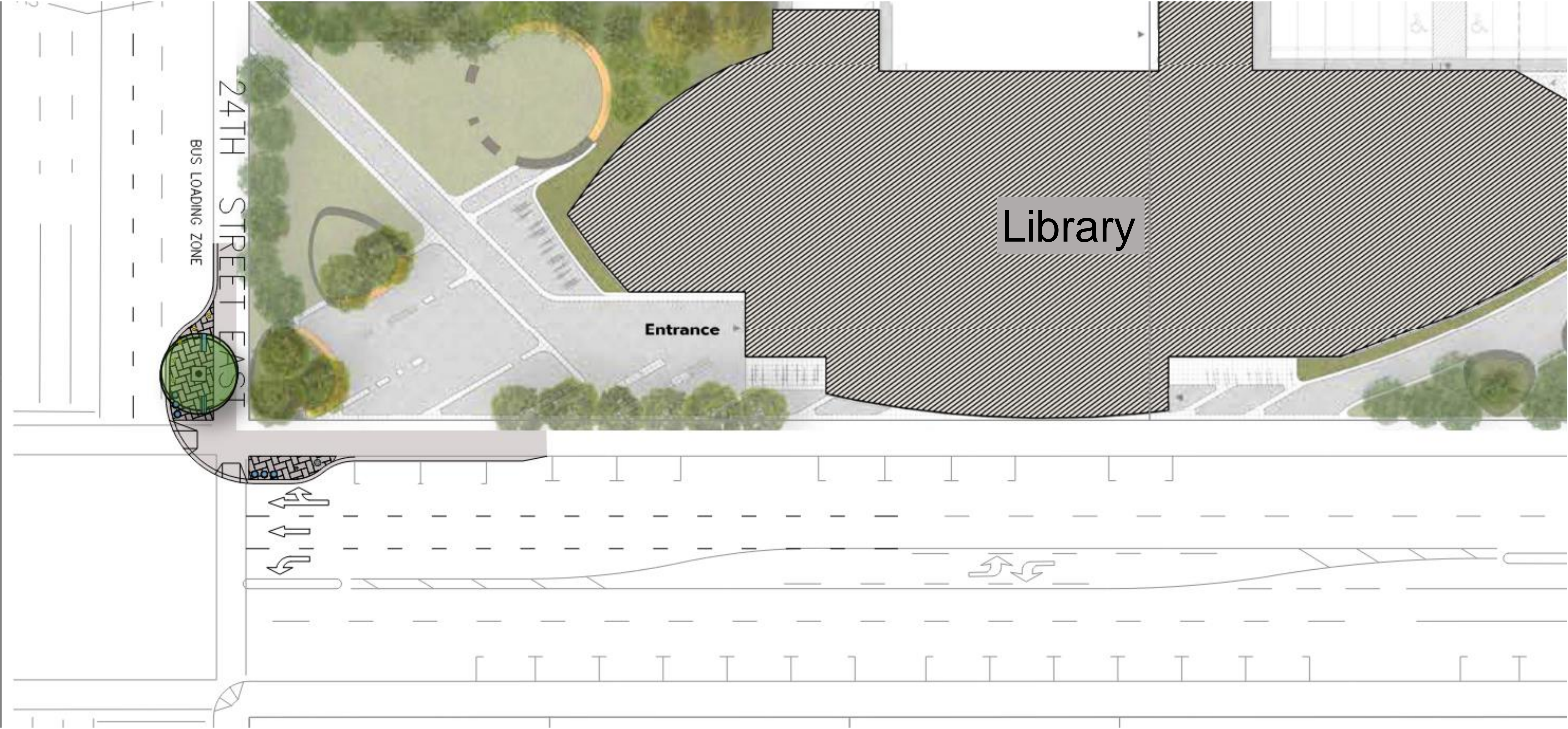

Estimated Cost: \$300,000

Question and Answer

We invite you to share your feedback and ideas to:

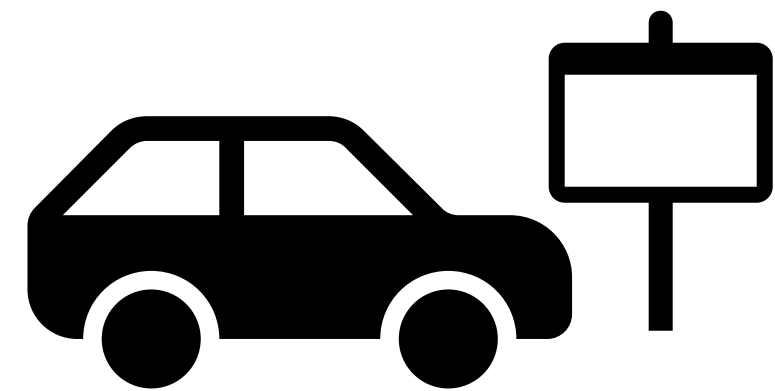

1. Improve accessible parking options



2. Make the corridor more accessible for everyone

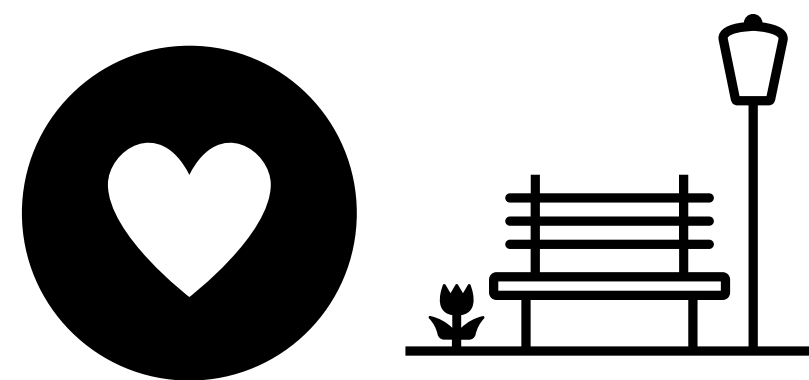

3. Beautify the area to make it more welcoming

Your Feedback

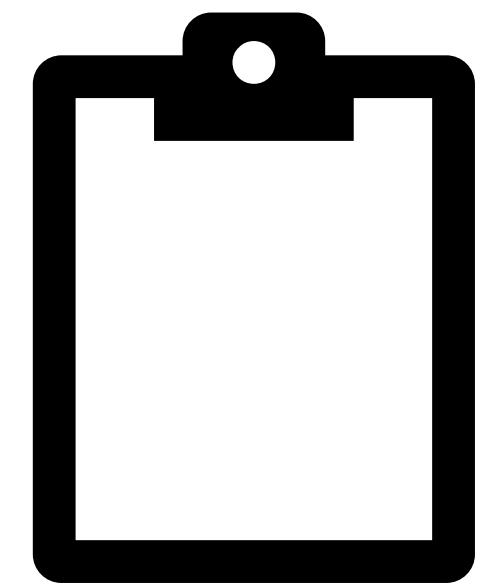

Complete the Survey

Open from June 12 to 26, 2024

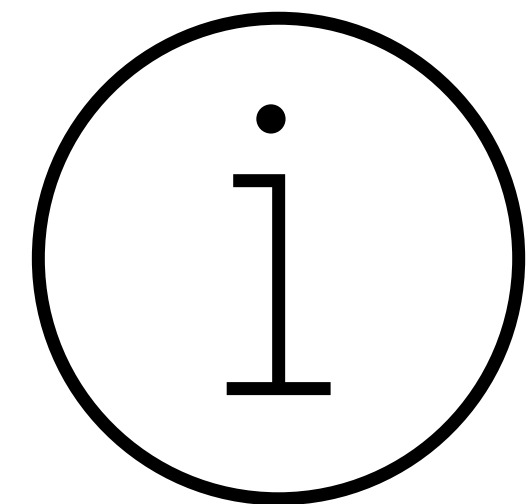

Stay up to date

Visit the project website at:

saskatoon.ca/engage/2nd-Ave-Parking



Next Steps

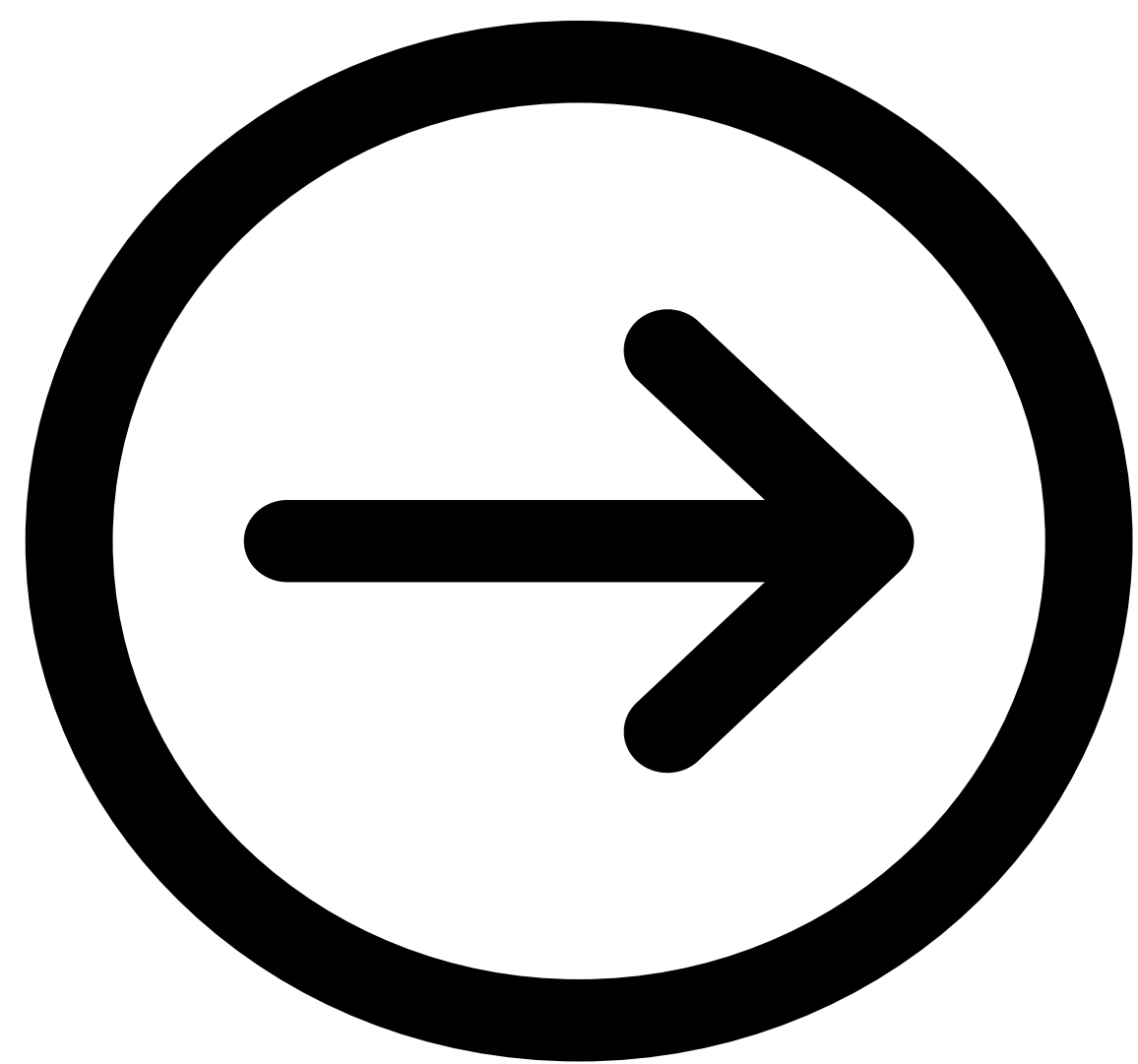

In the summer, we will finalize the recommended plan based on feedback and technical analysis and present to the Standing Policy Committee on Transportation.



Thank you!

